

- NEW POLE NOTES**
- 35 to 36 SET 35' C2 POLE
INSTALL 12" HORIZONTAL PIN STANDOFF BRACKET PER O.S. 112C
 - 37 SET 35' C2 POLE
INSTALL DOUBLE DIRECTION FEEDER CABLE DEAD-END PER O.S. 112B
INSTALL ARRESTOR, 1-10' GND. ROD PER O.S. 111
INSTALL 2 ANCHORS & 2 ANCHOR GUYS (NORTH & SOUTH) PER O.S. 101
F.R.T.M. TO INSTALL SPAN WIRE PER O.S. 102A & FEEDER TAP & TO REMOVE EXISTING MAST ARM
 - 38 to 39 SET 35' C2 POLE
INSTALL 12" HORIZONTAL PIN STANDOFF BRACKET PER O.S. 112C
 - 39 SET 35' C2 POLE
INSTALL 12" HORIZONTAL PIN STANDOFF BRACKET PER O.S. 112C & ARRESTOR & 1-10' GND. ROD PER O.S. 111
F.R.T.M. TO INSTALL SPAN WIRE PER O.S. 102A & FEEDER TAP & TO REMOVE EXISTING MAST ARM
 - 40 SET 35' C2 POLE
INSTALL 12" HORIZONTAL PIN STANDOFF BRACKET PER O.S. 112C
 - 41 SET 35' C2 POLE
INSTALL ARRESTOR, 1-10' GND. ROD PER O.S. 111 & DOUBLE DIRECTION FEEDER CABLE DEAD-END PER O.S. 112B
INSTALL 1 ANCHOR & 1 ANCHOR GUY (WEST) PER O.S. 101
F.R.T.M. TO INSTALL MAST ARM (TRANSFER FROM POLE 35) & FEEDER TAP
- EXISTING POLE NOTES**
- 35, 36 INSTALL 24" HORIZONTAL PIN STANDOFF BRACKET PER O.S. 112C
 - 37 INSTALL 24" HORIZONTAL PIN STANDOFF BRACKET PER O.S. 112C
INSTALL DOUBLE DIRECTION FEEDER CABLE DEAD-END PER O.S. 112B
 - 38 F.R.T.M. TO REMOVE MAST ARM (TRANSFER TO POLE 35)

1. For electrical isolation during bridge construction, install one section insulator per Overhead Standard 110, with enclosed hand operated disconnect switch, located on pole B, drawing no. 2001-2.

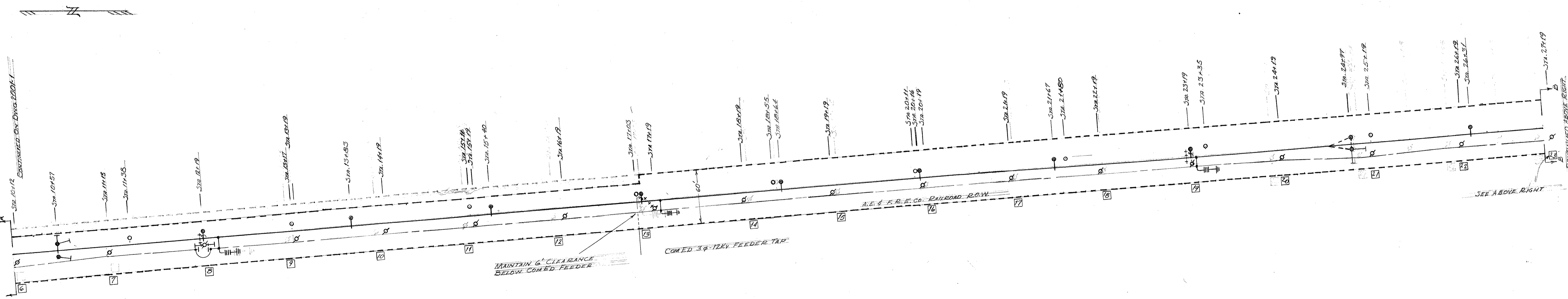

- NEW POLE NOTES**
- 6 to 7 SET 35' C2 POLE
INSTALL 12" HORIZONTAL PIN STANDOFF BRACKET PER O.S. 112C
 - 8 SET 35' C2 POLE
INSTALL DOUBLE DIRECTION FEEDER CABLE DEAD-END PER O.S. 112B
INSTALL ARRESTOR, 1-10' GND. ROD
INSTALL 2 ANCHORS & 2 ANCHOR GUYS (NORTH & SOUTH) PER O.S. 101
F.R.T.M. TO INSTALL SPAN WIRE PER O.S. 102A & FEEDER TAP & TO REMOVE EXISTING MAST ARM
 - 9 to 10 SET 35' C2 POLE
INSTALL 12" HORIZONTAL PIN STANDOFF BRACKET PER O.S. 112C
 - 11 SET 35' C2 POLE
INSTALL 12" HORIZONTAL PIN STANDOFF BRACKET PER O.S. 112C
INSTALL ARRESTOR & 1-10' GND. ROD PER O.S. 111
F.R.T.M. TO INSTALL SPAN WIRE PER O.S. 102A & REMOVE EXISTING MAST ARM & INSTALL FEEDER TAP
 - 12 to 13 SET 35' C2 POLE
INSTALL 12" HORIZONTAL PIN STANDOFF BRACKET PER O.S. 112C
 - 14 SET 35' C2 POLE
INSTALL ARRESTOR & 1-10' GND. ROD PER O.S. 111
F.R.T.M. TO INSTALL SPAN WIRE PER O.S. 102A, REMOVE EXISTING MAST ARM & INSTALL FEEDER TAP
 - 15 to 16 SET 35' C2 POLE
INSTALL 12" HORIZONTAL PIN STANDOFF BRACKET PER O.S. 112C

Joseph A. Taylor
July 25, 2008

600 VOLT D.C. OVERHEAD FEEDER INSTALLATION		
SCALE 1"=50'	CHECKED BY: C.R.G.	DR. BY: R.R.T.
DATE: 7/25/08	APPROVED BY: J.A. Taylor	REV. 03/10/01
FOX RIVER TROLLEY MUSEUM		
SOUTH ELGIN, ILLINOIS		
CHICAGO SIGNAL & ENGINEERING CO.	DWG. NO. 2001-2	
ELECTRICAL ENGINEERS		

NOTE: FOR SYMBOLS, SEE KEY ON DWG. 2001-1